

IMPORTANT! KEEP THIS MANUAL FOR FUTURE REFERENCE

INSTRUCTION MANUAL FOR BABY STROLLER "TERRA"

**STROLLER
TERRA**



This stroller **chipolino** has been manufactured in accordance with the Product Safety Directive 2001/95/EU of the European Parliament and The Council and with European standard EN 1888 „Child care articles. Wheeled child conveyances. Safety requirements and test methods“ and the regulations of national law, including Consumer Protection Law.

FOLLOW ALL WARNINGS, INSTRUCTIONS AND RECCOMENDATIONS IN THIS MANUAL IN ORDER TO GUARANTEE THE SAFE USE OF THIS PRODUCT:

CAUTION! WARNINGS!

- ❖ NEVER LEAVE YOUR CHILD UNATTENDED!
- ❖ THE CARRY COT IS SUITABLE ONLY FOR A CHILD, WHO CANNOT SIT UNAIDED, ROLL OVER AND CANNOT PUSH ITSELF ON ITS HANDS AND KNEES!
- ❖ USE THE POSITION FOR SITTING AFTER YOUR CHILD TURNS 6 MONTHS!
- ❖ KEEP AWAY FROM FIRE!
- ❖ DO NOT LIFT THE STROLLER BY THE FRONT BAR, BECAUSE THIS CAN LEAD TO SERIOUS INJURIES!
- ❖ ALWAYS USE SAFETY BELTS!
- ❖ MAKE SURE THAT ALL LOCKING MECHANISMS ARE ENGAGED BEFORE PLACING THE CHILD IN THE STROLLER.
- ❖ DO NOT CHANGE BACKREST POSITIONS WHILE THE SEAT IS IN CARRY COT MODE!
- ❖ MAKE SURE YOUR CHILD IS AT SAFE DISTANCE AWAY FROM THE STROLLER DURING ADJUSTMENTS, FOLD OR UNFOLD OF THE STROLLER.
- ❖ DO NOT ALLOW YOUR CHILD TO USE STROLLER AS A TOY!
- ❖ ALWAYS CHECK IF THE ATTACHMENT DEVICES OF SEAT UNIT OR CAR SEAT ARE PROPERLY FIXED TO THE STROLLER'S FRAME BEFORE USAGE.
- ❖ THE STROLLER IS NOT SUITABLE FOR RUNNING OR SKATING!
- ❖ Use the stroller for a child weighing not more than 15 kg.
- ❖ Initial assembly, folding and unfolding to be done only by adult!
- ❖ Do not put additional mattress, thicker than 20 mm!
- ❖ Always activate the parking device when the stroller has stopped and is not moving, especially when you place or take out your child from it!
- ❖ Make sure the safety belts are fastened and fit well to the child before usage.
- ❖ The maximum load for storage basket is 2 kg
- ❖ Do not overload the stroller! Always balance your stroller in a way to keep it stable and prevent the risk of tip-over!
- ❖ Stroller is intended for use for one child at a time!
- ❖ Do not use any spare parts or other components, which are not approved by the producer! The producer does not take any responsibility for the safety of the child when you have not used the proper and original spare parts, approved

and provided by him!

- ❖ Do not apply any changes or modifications to the stroller's construction! Contact the dealer or an authorized repair service for advice and/or repair instead!
- ❖ Car seat does not replace a carrycot or a bed. Should your child need to sleep, then he should be placed in a suitable cot or bed.
- ❖ Discontinue the usage, if you find worn out or loose joints, damaged or missing parts! There is a risk of injury of the child!
- ❖ Do not allow children younger than 3 years near the stroller during the assembly or disassembly, in order to prevent the risk of injury or swallowing of small parts!
- ❖ Strings can cause strangulation! Do not place additional strings to the product to avoid injuries!
- ❖ Never use the stroller on stairs or escalators! Use extra care when going up or down a pavement or step!
- ❖ The packaging of the product must be kept out of the reach of children to avoid the risk of strangulation!



MAIN FEATURES

- ❖ Seat unit is suitable for one child aged 0-36 months weighing not more than 15 kg;
- ❖ Seat unit transforms into cot which is suitable for baby up to 6 months with weight max 9 kg;
- ❖ Car seat “Terra”, Group 0+ (0-13 kg). It is safe and compatible with Terra stroller's frame.

Note: Car seat is sold separately. All instructions and recommendations for safety usage and installation are given in separate user's manual

- ❖ Seat unit can be installed in 2 directions – forward facing and rearward facing;
- ❖ 5-point safety harness system
- ❖ Adjustable backrest recline;
- ❖ Adjustable canopy;
- ❖ Front wheels can swivel or move straight.

ДИАГРАМА НА ОСНОВНИТЕ ЧАСТИ



ASSEMBLY INSTRUCTIONS AND FUNCTIONS

This stroller is supplied partially assembled. In order to complete the assembly, you don't need any tools.

IMPORTANT! Follow exactly the instructions given and check the pictures. Keep your hands from entrapment!

IMPORTANT! After each operation, make sure that you have followed the instructions correctly and the fixing is stable!

IMPORTANT! In most cases after the completion of an operation you will hear a clicking sound.

The assembly, disassembly and functions are numbered from 1 to 16. Use the operations descriptions given in this manual and their matching picture

ASSEMBLY

– FRAME UNFOLDING

2 – INSTALLATION AND REMOVAL OF REAR WHEELS

3 – INSTALLATION AND REMOVAL OF FRONT WHEELS

4 – INSTALLATION AND REMOVAL OF SEAT UNIT

5 – INSTALLATION AND REMOVAL OF BUMPER

Note: To remove the front bumper press the buttons on both sides and remove the bumper.

6 – INSTALLATION AND REMOVAL OF CANOPY

CAUTION! Always attach the canopy at the back of the seat in order to prevent the child from sliding off and injury.

FUNCTIONS

7 – SWIVEL AND STRAIGHT MOTION OF FRONT WHEELS

IMPORTANT! When using the stroller on uneven surfaces, fix the wheels for straight movement only.

8 – PARKING DEVICE

9 – HANDLE HEIGHT ADJUSTMENT

9-1 – Press

9-2 – Move in the desired position.

Note: The fixing of each position is accompanied with the sound “click”.

10 - CANOPY ADJUSTMENT

11 – SEAT POSITION ADJUSTMENT

12 - REASTRAINT SYSTEM (5-POINT SAFETY HARNESS)

CAUTION! Belts must be snug to child’s body and must not be twisted.

IMPORTANT! Periodically check to ensure that the seat belt is securely attached to the stroller frame as well as securely fastened. The seat belt straps must not be damaged, worn out or twisted.

13 – STROLLER FOLDING

IMPORTANT! Before folding the stroller, activate the parking device, the seat must be forward facing and front wheels must be in swivel function, the canopy must be closed and storage basket should be empty.

After folding, attach the transport hook.

14 – TRANSFORMING THE COT INTO SEAT

15 - TRANSFORMING THE SEAT INTO COT

Unfasten the belts on bottom side of the seat.

CAUTION! When the seat is in carry cot mode, it must be in rearward position – child facing the mother.

IMPORTANT! When the seat is transformed in carry cot, always remove the harness or tuck them the sides of the seat and cover them with a pad/mattress/ with thickness up to 20 mm.

16 – INSTALLATION AND REMOVAL OF CAR SEAT “TERRA” ON FRAME OF STROLLER TERRA.

You can install Milo car seat on the frame of this stroller using adaptors.

Press the corresponding red button on top side of car seat and insert:

- Adapter marked „R” on the right side of car seat (when you are facing the car seat)
- Adapter marked „L” on the left side of car seat (when you are facing the car seat)

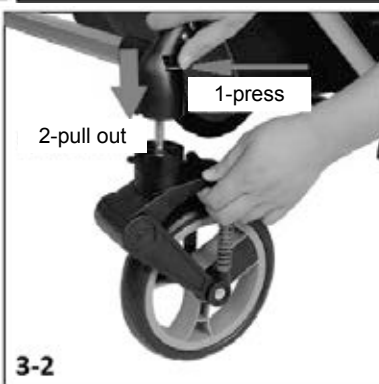
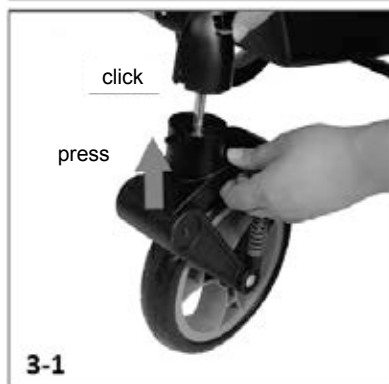
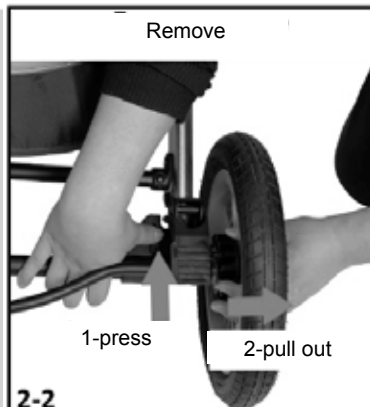
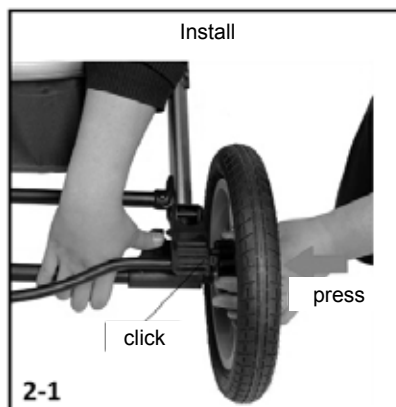
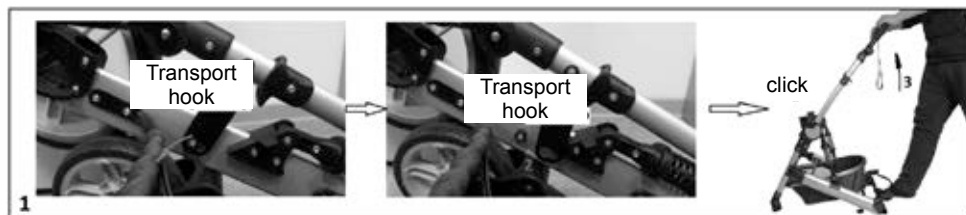

Installation

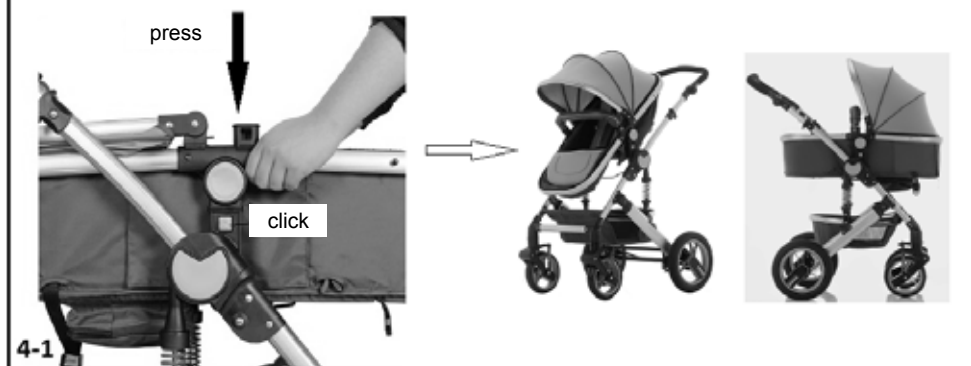

Removal

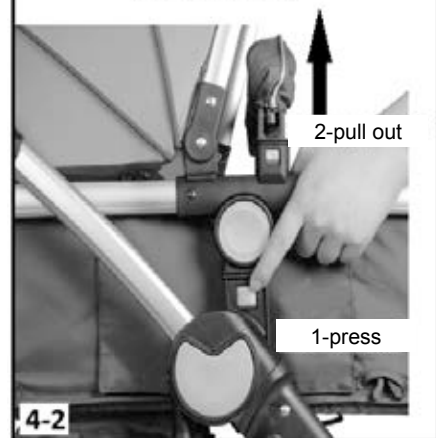

1-press

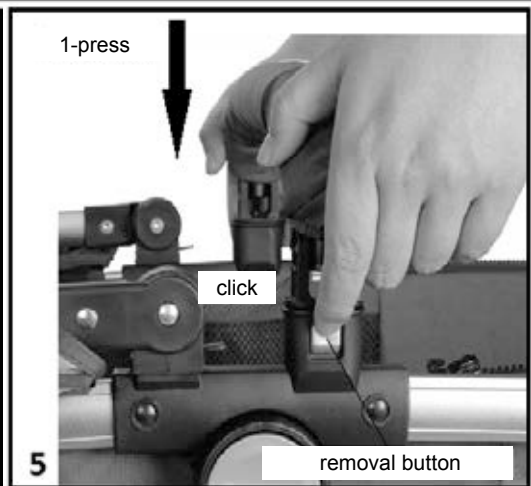

Installation

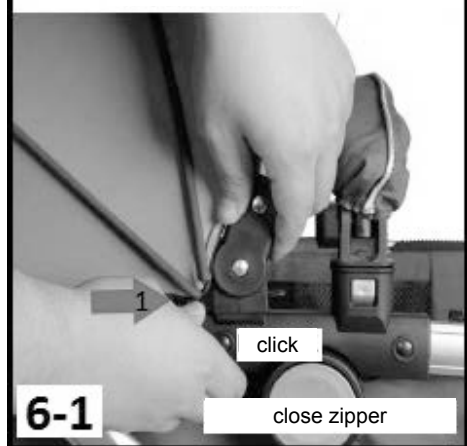

Removal

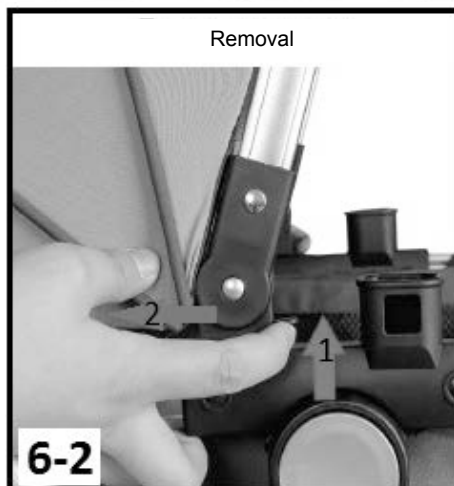

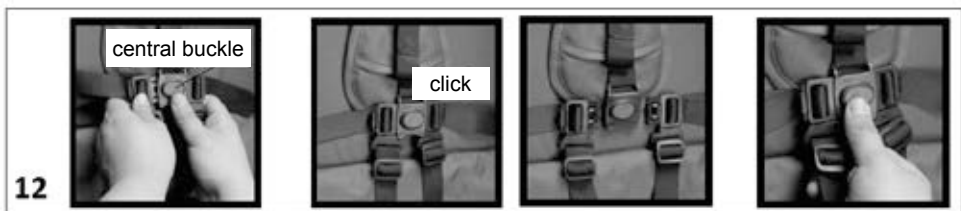
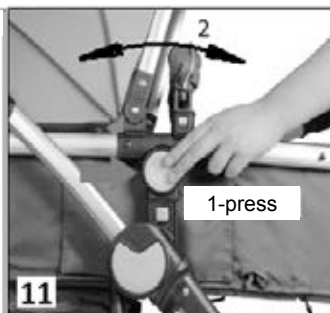
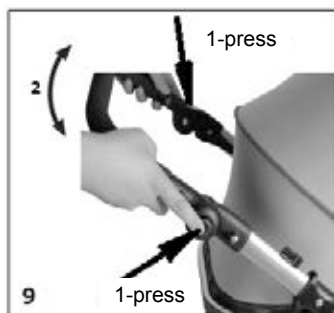
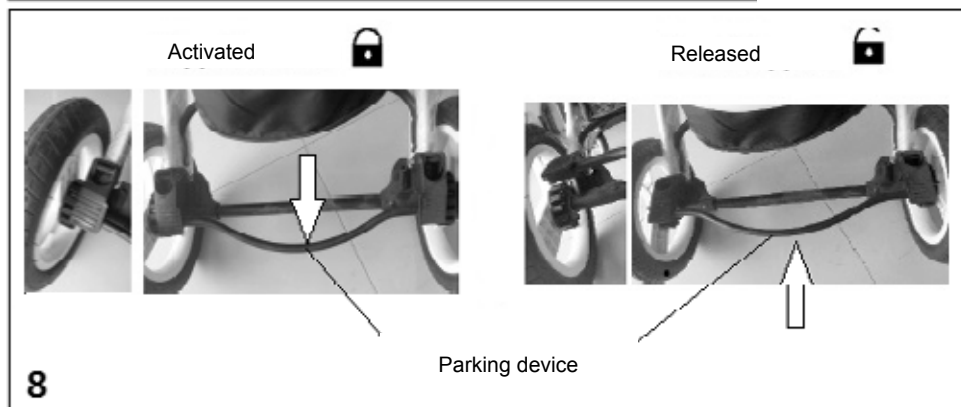
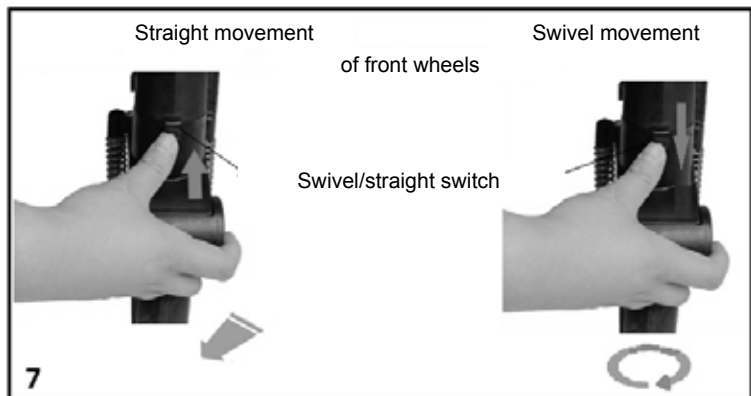

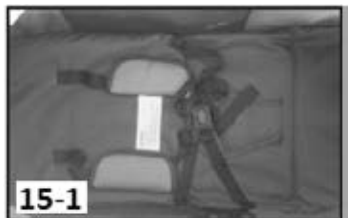

CARE AND MAINTENANCE GUIDELINES

- ❖ The brakes and wheels wear out faster than other parts. Replace them when necessary.
- ❖ Regularly oil the moving parts. Use silicone oil or silicone spray for oiling.
- ❖ Clean and oil all dirty metal and plastic parts regularly.
- ❖ Clean the fabrics, plastic parts and metal parts with damp cotton cloth or sponge and mild soap.
- ❖ Do not use aggressive detergents, solvents, bleach or spirits to clean your stroller.
- ❖ Always leave the stroller to fully dry after cleaning before you use it or store it. Mold could form if you keep your stroller moist.
- ❖ Always store your stroller indoors. The effect of the environment – sea air, road covered with salt, acid rains, etc., as well as storing in the open air lead to corrosion.
- ❖ Please, contact your authorized dealer for problems connected with the use or repair of this stroller.

Fabric Composition:

Outer: Polyester, PU leather

Filling: 100% Polyester



KKTER01xxxx

Used materials: plastic, textile, metal



Bulgaria, Plovdiv, Str. Golyamokonarsko shosse №1
www.chipolino.com